

E26 (MB) Indoor Luminaires

Ceiling Mount – Pendant or Closest to Ceiling

120VAC / 60Hz

Model #: CLNPxxMBxx-xxxx

Safety Precautions

- Read all safety precautions and installation instructions carefully before installing or servicing this fixture. Failure to comply with these instructions could result in potentially fatal electric shock and/or property damage.
- It is recommended that a qualified electrician perform all the wiring. This fixture must be wired in accordance with all national and local electrical codes.
- Do not handle any energized fixture or attempt to energize any fixture with wet hands or while standing on a wet or damp surface or in water.
- This fixture is designed for use in a 120VAC circuit. This fixture is not compatible with dimming circuit.
- Make sure that the power source conforms to the requirements of the fixture. (See labels on the fixture housing).
- To reduce the risk of electrical shock, and to assure proper operation, this fixture must be adequately grounded. To accomplish proper grounding, there must be a separate ground wire (green) contact between this fixture and the ground connection of your main power supply panel.
- This fixture is intended to be used for general indoor lighting in dry or damp locations.

Assembly Instructions

Step 1 – Preparing for installation

- A. **Disconnect electrical power** at the fuse or circuit breaker box before installing or servicing any part of this fixture.
- B. Carefully remove the fixture and hardware kit from the carton.
- C. Remove components from the hardware kit. Note: kit can be configured as closest to ceiling (Figure 1) or pendant (Figure 2) depending on your application.
- D. Fixture is provided with 108" adjustable power cord and 60" sectional stems (9) that can be extended with optional accessory. The standard stems (9) included are four 12" and two 6" long to make pendant. And an alternate wobble fitting with stem (15) to make closest to ceiling.
- E. Install mounting bracket (1) to the 3-0 or 4-0 junction box (not included) using two screws (2) to secure it.
- F. Pull the black, white, and ground supply power source wires down on one side of the mounting bracket.
- G. Install nipple (3) on the mounting bracket (1) allowing 1" to protrude outward then using jam nut to secure it.
- H. **For Closest to Ceiling (Figure 1) application:** feed power cord inside the wobble fitting with stem (15) then tighten it to the nipple on the socket hub (11) to secure it. Note: unused components can be discarded after installation is completed.
- I. **For Pendant (Figure 2) application:** assemble the stems (9), top loop fitting (8) and bottom loop fitting (10) to one another as needed to achieve desired drop height. It is easier to feed fixture power cord through each stem prior to connecting them together. Turn clockwise to tighten and secure bottom fitting (10) to the nipple on the socket hub (11) then tighten top loop fitting (8) to secure it. Install top coupler fitting (5) to the top loop fitting (8) using link lock (6) to secure them together. Note: unused components can be discarded after installation is completed.
- J. Feed the fixture power cord through the canopy nut (7), canopy (4) and nipple (3). Leave excess fixture power cord hanging loose on the same side as the wires from the supply power source.
- K. Install the fixture assembly with the fittings (15) or (5) to the nipple (3) then tighten to secure it.
- L. Make certain that fixture is at the appropriate height above the finish floor before trimming the cord. Carefully trim excess fixture power cord but leave about 16" long for connection to the supply power source. Strip off the insulation to expose 3/8" bare conductor needed to make electrical connections.

Wiring – All wiring must take place inside the junction box (not included)

Caution: Make sure power is off at the fuse or circuit breaker box. Check power wires for damage or scrapes. Use wire suitable for at least 90°C (194°F). **Note:** Most dwellings built before 1985 have supply wire rated to 60°C. Consult a qualified electrician to ensure correct branch circuit conductor before installing.

Step 2 – Wiring fixture

- A. Make all wire connections to appropriate wire. Secure with wire nuts (provided).
- B. Connect the green wire from the fixture to the supply power source ground wire.
- C. Connect the black wire from the fixture to the black (L) wire from the supply power source.
- D. Connect the white wire from the fixture to the white (N) wire from the supply power source.
- E. Pull on each wire lead to make sure connections are secure. Make certain no bare wires are exposed outside of wire connectors. Tuck all connections neatly into the junction box.

Step 3 – Mounting fixture

- A. Install the canopy (4) over the mounting bracket (1) then tighten canopy nut (7) to secure it.

Step 4 – Mounting shade

- A. Install the shade (13) on the socket hub (11) by aligning the top bracket with holes on the pin (12) then lower it on the hub to secure it. Make certain all supporting brackets are securely inside the pins.
- B. Install crystal ball (14) onto the bottom finial.

Step 5 – Lamping (not included)

- A. Install medium base bulb (not included) into socket and twist clockwise rotation until securely snug. Use only E26, Max 60W Type A. Repeat until all bulbs are installed.

E26 (MB) Indoor Luminaires
Ceiling Mount – Pendant or Closest to Ceiling
120VAC / 60Hz

Model #: CLNPxxMBxx-xxxx

Step 6 – Restore power at the fuse or circuit breaker box

FIXTURE SIZE
 18-24 INCH: 3 BULBS REQ'D
 25-36 INCH: 5 BULBS REQ'D

TO MAKE CLOSEST TO CEILING

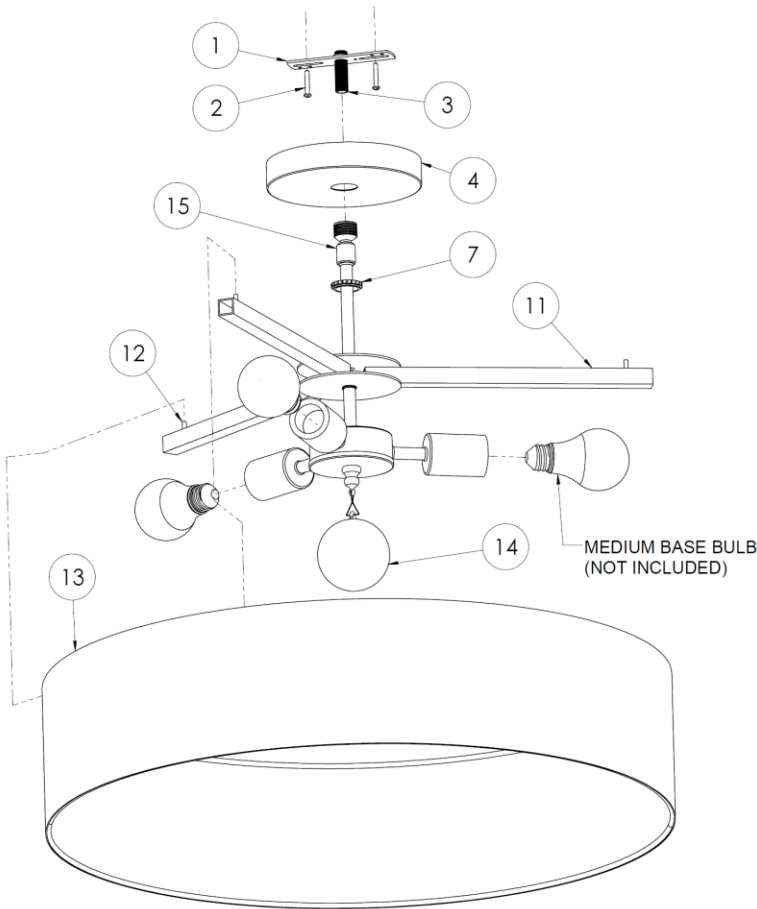

FIGURE 1

TO MAKE PENDANT

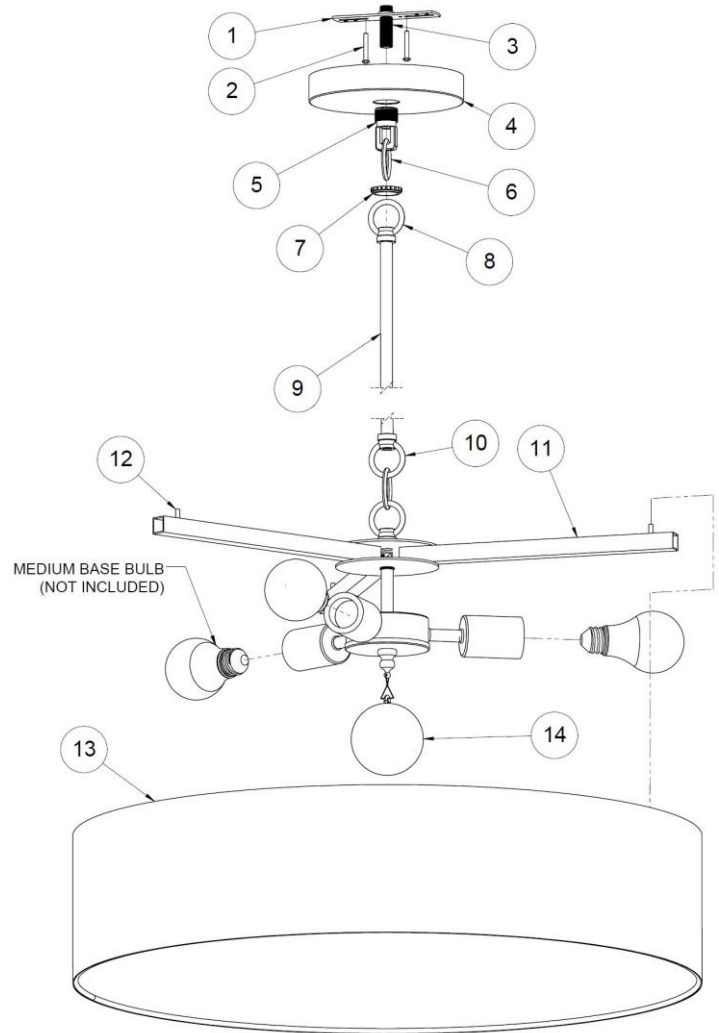

FIGURE 2

View shown for reference only. Individual models may vary.

Limited Factory Warranty

AFX Inc. hereby warranty that this fixture is free from defects in materials and workmanship when installed and used under normal operating conditions for a period of 2 years from date of shipment from factory. This warranty covers all component parts and extends only to replacement of defective fixture or components; it does not cover failure due to improper installation, misuse, mishandling or damage incurred in transit.